



---

**SIERRA WIRELESS:  
MP70**

# QUICK-START GUIDE

**FEBRUARY 2018**



---

## CONTACT

### Address

**KELTEK Incorporated**  
205 North High Street  
Baxter, Iowa 50028  
United States

### Phone & Fax

Free Toll: +1 855 855 0328  
Phone: +1 641 227 2222  
Fax: +1 641 227 2323

### Online

Email 1: [sales@keltekinc.com](mailto:sales@keltekinc.com)  
Email 2: [service@keltekinc.com](mailto:service@keltekinc.com)  
Website: [www.keltekinc.com](http://www.keltekinc.com)

---

# SIERRA MP70 QUICK-START GUIDE

## GENERAL TROUBLESHOOTING:

01 //

### HOW TO INSERT A SIM CARD

1. Use a #1 Phillips screwdriver to remove the SIM card cover.
2. Slide the primary SIM card in brass side down until it clicks into place.
3. If you are using a dual cellular setup, the secondary SIM will go into the lower slot, brass side up.
4. Once installed, you may re-attach the cover.

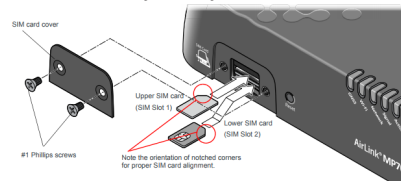

Figure 2-1: Installing the SIM Card

4. Replace the SIM card cover.

02 //

### LED BEHAVIOR

1. Use a #1 Phillips screwdriver to remove the SIM card cover.
2. Slide the SIM card in brass side up until it clicks into place.
3. If you are only using a single cellular plan, the SIM will go into slot A1
4. If you are using dual cellular plans, the SIMs will go into slot A1 and B1

LED	Color/Pattern	Description
GNSS	Solid Green	Satellite fix available
	Flashing Amber	No satellite fix available
	Off	
Wi-Fi	Solid Green	Wi-Fi enabled (any mode), and not connected to an access point
	Flashing Green	Transmitting/receiving over Wi-Fi while not connected to an access point
	Solid Amber	Wi-Fi connected to an access point (i.e. Network state is "Network Ready - Wi-Fi")
	Flashing Amber	Transmitting/receiving over Wi-Fi while connected to an access point
	Off	Wi-Fi is off
Network	Flashing Amber	Connecting to a network
	Flashing Green	Connected to WAN (over cellular, Wi-Fi, or Ethernet)
	Solid Green	Connected to VPN
	Off	No network connection
Signal		If the active WAN link is:
		• Cellular—Signal shown is for the cellular radio for that link.
		• Other (Wi-Fi, Ethernet, etc.)—Signal shown is for the strongest cellular radio.
	Solid Green	Good signal ( ≥85 dBm; equivalent to 4–5 bars)
	Solid Amber	Average signal ( ≥100 dBm, <-85 dB; equivalent to 2–3 bars)
	Red	Poor signal ( ■100 dBm; equivalent to 1 bar)
Activity	Flashing Green	Transmitting/receiving over the WAN interface
	Off	No WAN Activity
Power	Solid Green	Power is present, normal operation
	Flashing Green	Power is present, MG90 is booting
	Solid Amber	Standby mode
	Flashing Red	• Slow blink (1 per second)—Temperature out of operating range (see Temperature (operational) on page 31) • Fast blink (4 per second)—Voltage out of operating range
	Off	No Power
All LEDs	Green LED chase	Radio module update is in progress
	Amber LED chase	Software update is in progress
	Solid White	Factory default reset is in progress When the factory reset finishes, the MG90 will power off and, if AutoPower is enabled (LCI General > Startup tab), will reboot.

03 //

## POWER LIGHT IS FLASHING RED AND NOT POWERING UP

1. Ensure that the vehicle is running.
2. Check the ignition and power fuses in the yellow fuse holders.
3. If the MP70 still won't boot, contact Keltek for service.

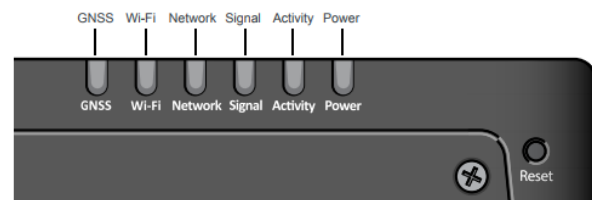

Figure 2-15: MG90 LED Status Indicators (front panel)



---

**KELTEK INCORPORATED**

**THANK YOU FOR  
THE BUSINESS.**

---



---

**CONTACT**

**Address**

**KELTEK Inc.**  
205 North High Street  
Baxter, Iowa 50028  
United States



---

**SERVICE**

Direct Link : <https://www.keltekinc.com/service/>

---